

Eight Avenue
Heaton, Newcastle Upon Tyne NE6 5YB
£875 PCM

Floor Plan

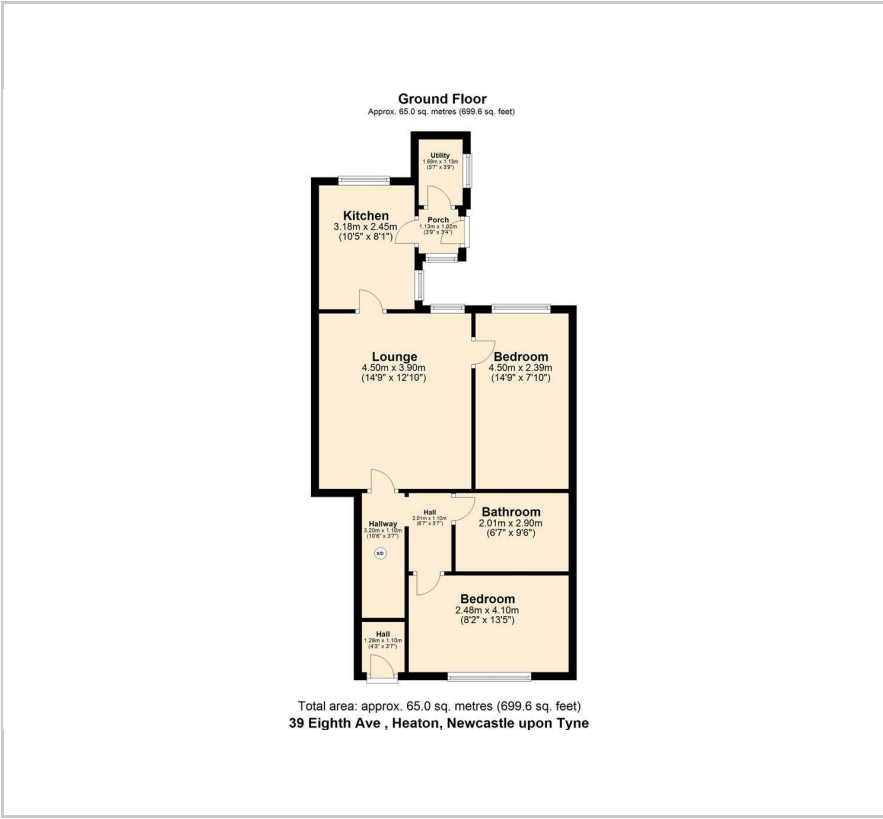

Area Map

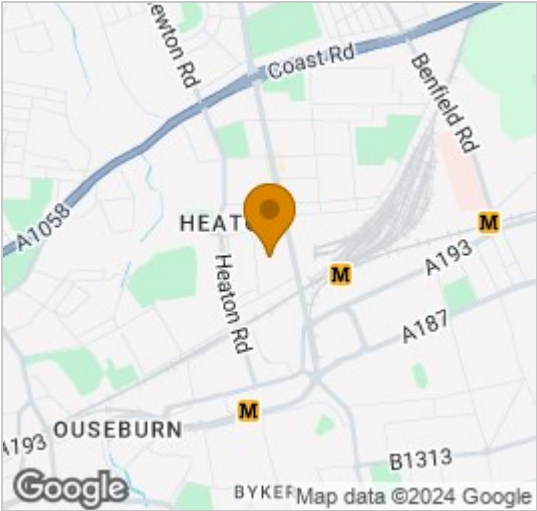

Energy Efficiency Graph

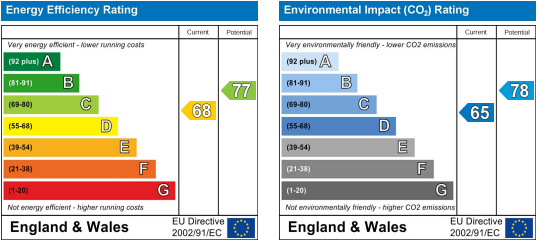

Viewing

Please contact our NEWCASTLE Office on 01912761111 if you wish to arrange a viewing appointment for this property or require further information.

- AVAILABLE 17TH SEPTEMBER ■ £875.00 PCM/ £100.00 PPPW 2025
- Ideal for professionals or students ■ Two double bedrooms
- Lounge with leather sofas ■ Fully equipped kitchen
- Electric shower over bath ■ Warmed via gas central heating
- Double Glazed ■ Furnished



AVAILABLE 17TH SEPTEMBER 2025 - £875.00 PCM/ £100.00 PPPW. Easy access to Chillingham Road and Newcastle City Centre. The property briefly comprises of two bright double bedrooms, fully furnished lounge, bathroom has electric shower over bare, toilet and basin.

Ideal for professionals and students alike. Local transport links, facilities & amenities include a wide choice of local shops and supermarkets, a main bus route and Metro train through Newcastle City and North Tyneside.

Disclaimer

Every care has been taken with the preparation of these particulars but complete accuracy cannot be guaranteed. If there is any point, which is of particular importance to you, we will be pleased to check the information for you. These particulars do not constitute part of a contract. Measurements are approximate.



These particulars, whilst believed to be accurate are set out as a general outline only for guidance and do not constitute any part of an offer or contract. Intending purchasers should not rely on them as statements of representation of fact, but must satisfy themselves by inspection or otherwise as to their accuracy. No person in this firms employment has the authority to make or give any representation or warranty in respect of the property.